

accessories dominic

Installation

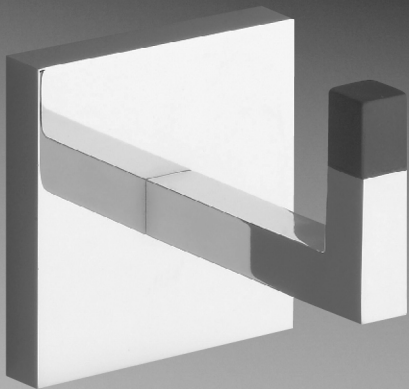

FRANZ
VIEGENER

Accessories Dominic Line



Towel bar
FV164/85 (17 11/16")
FV164.01/85 (23 5/8")
FV164.02/85 (29 1/2")



Robe hook
FV166/85

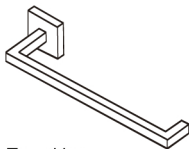

Towel bar
FV162/85

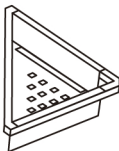

Triangular corner mount
soap dish(metal).
FV168.02/85M

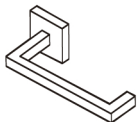

Toilet roll holder
FV167/85

Installation instructions

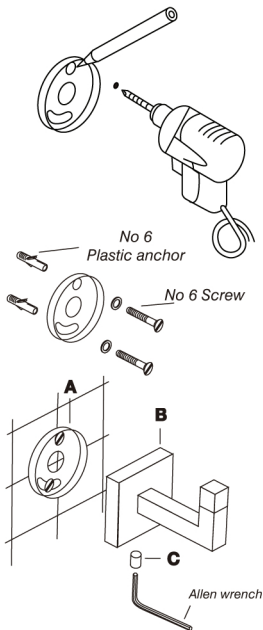

1_Using the support (in the position the figure shows), mark the place where you will drill the first hole to mount the accessory.

2_Make the necessary hole for No 6 plastic anchor.

3_Affix the support to the wall using the screws and the plastic anchors provided. Repeat the procedure (1 and 2) to complete the fixation of the support.

4_Place the accessory (B) over the support (A), keeping all pressed to the wall. Tighten the set-screw (C) with the Allen wrench provided.

Accessories with two supports

Assembling

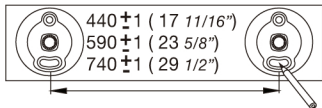

For accessories such as towel bars, please bear in mind the following:

a_Using the template attached to the towel bar, mark the places where you will drill. Take care to verify horizontals.

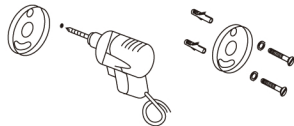

b_Follow previous instructions (1, 2 and 3) for affixing the supports.



c_Put the complete set together, without escutcheon. Tighten the supports (see picture).

d_Put set together with the escutcheons.