

Installation and maintenance / Instalación y mantenimiento

Before connecting the faucet to the water supply, flush the tubing thoroughly to eliminate any residue  
Antes de conectar la grifería a la distribución de agua, purgue muy bien la cañería a fin de eliminar partículas extrañas.

1/2" Thermostatic rough valve with mixer, stop valve and two outlets  
Base para válvula termostática de 1/2"

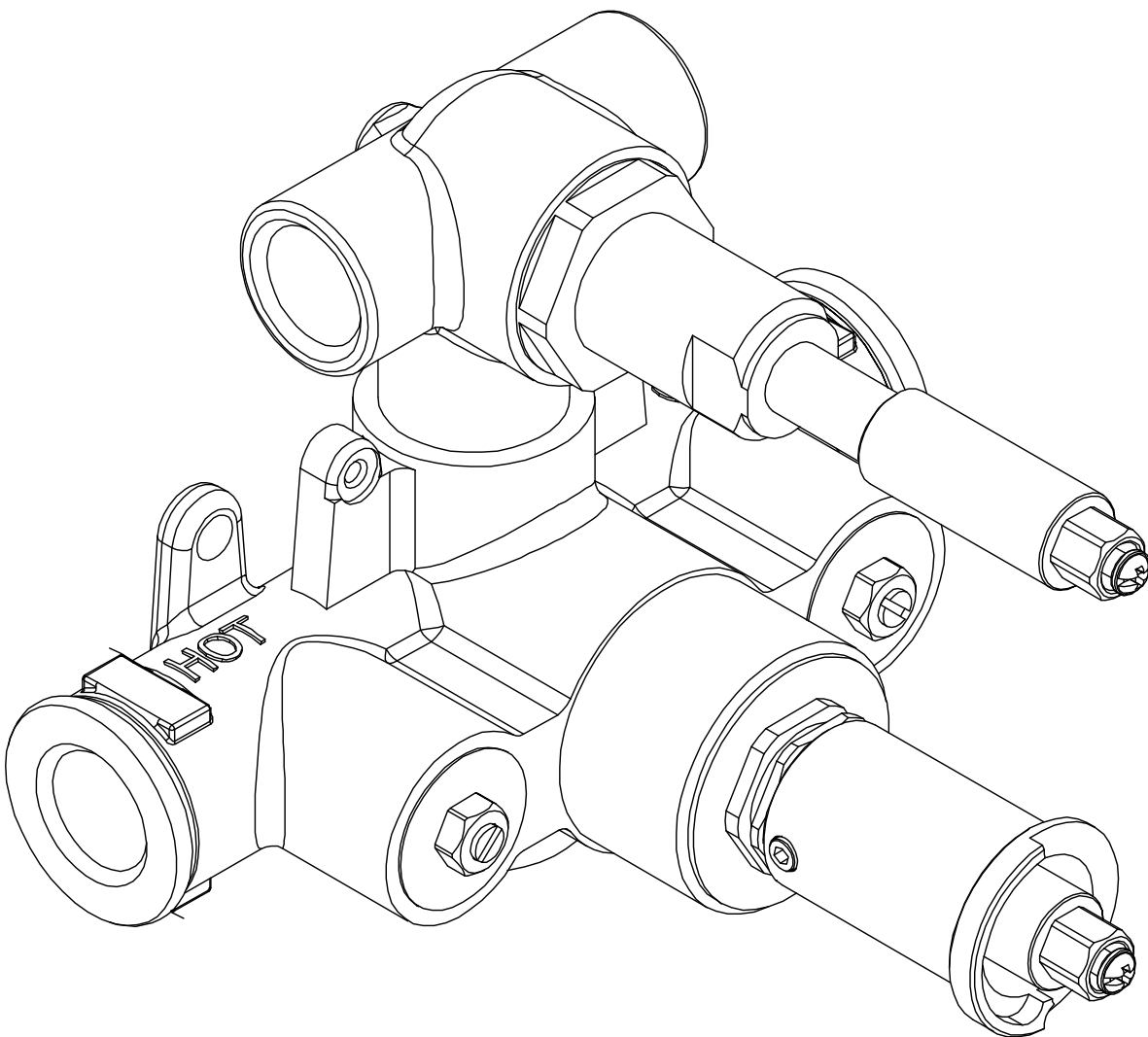

**Required installation tools / Herramientas necesarias para la instalación**

Provided / Provistas



1/2" NPT male plug  
Tapon macho 1/2" NPT

Not Provided / No Provistas

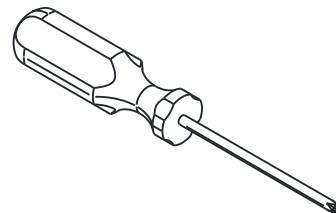

Phillips screwdriver  
Destornillador Phillips

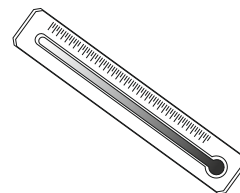

Thermometer  
Termómetro

## Exploded view / Vista explotada

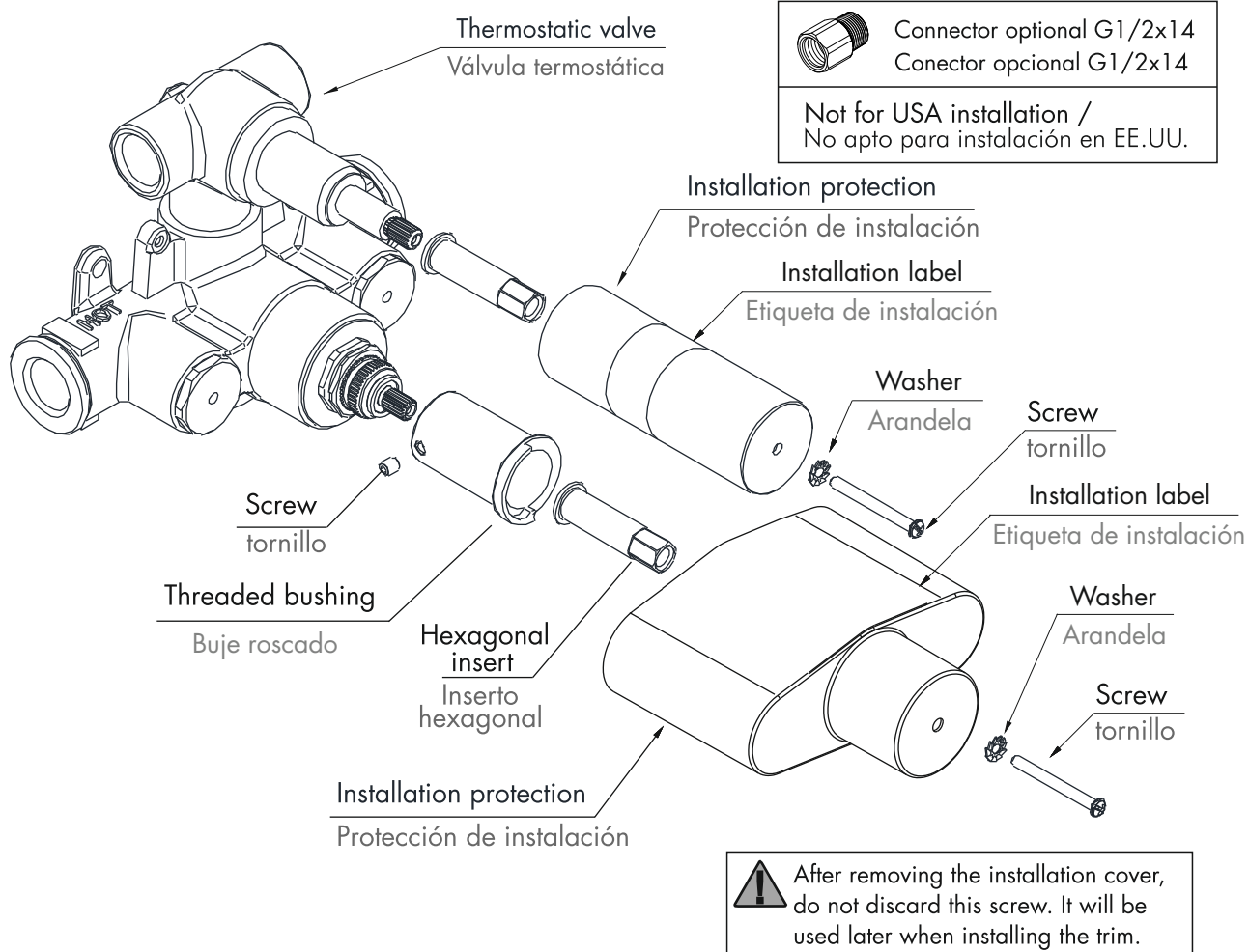

## Measures / Medidas

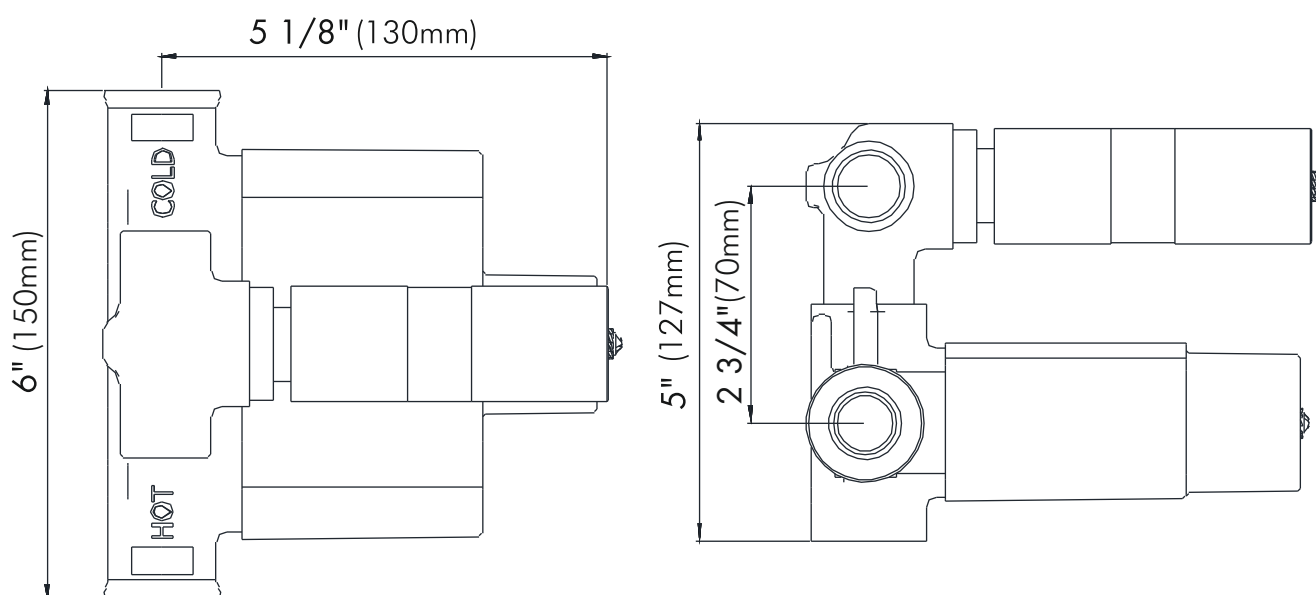

## Installation / Instalación

Minimum installation depth /  
Profundidad mínima de instalación

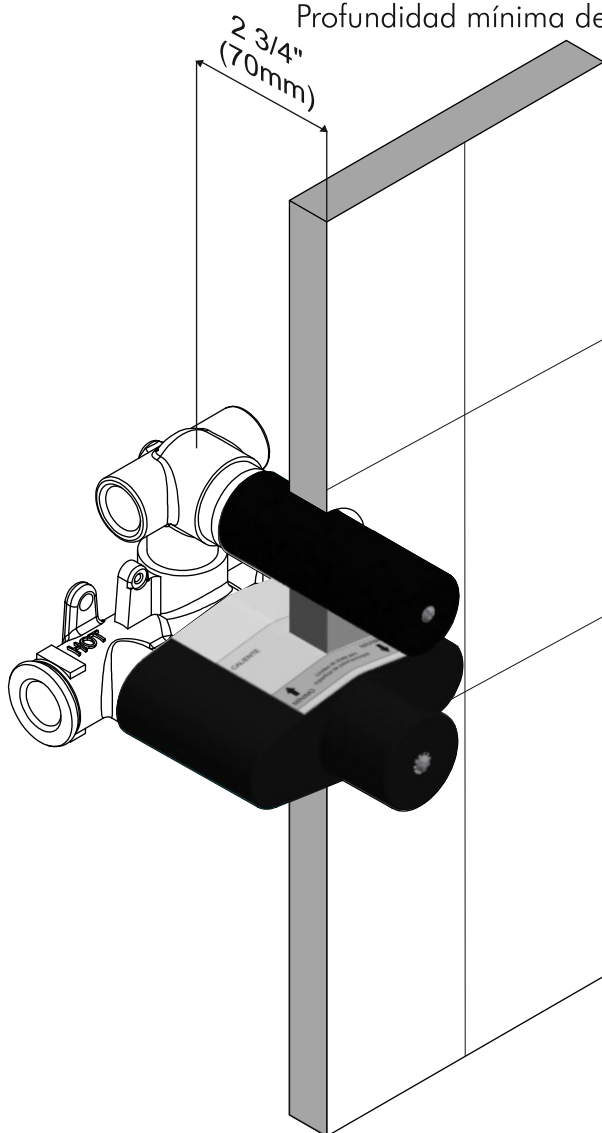

Maximum installation depth /  
Profundidad máxima de instalación

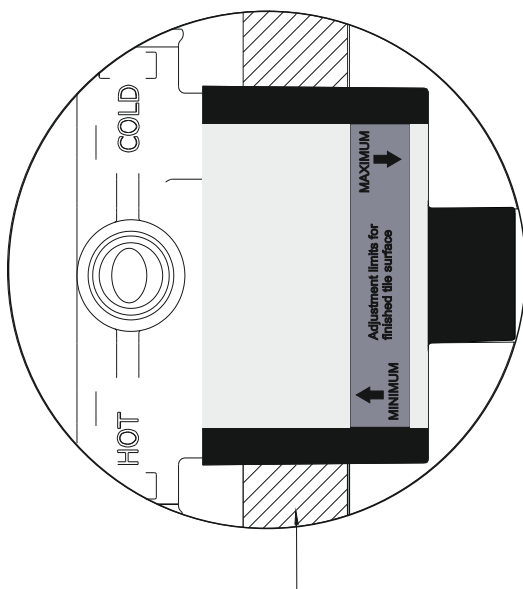
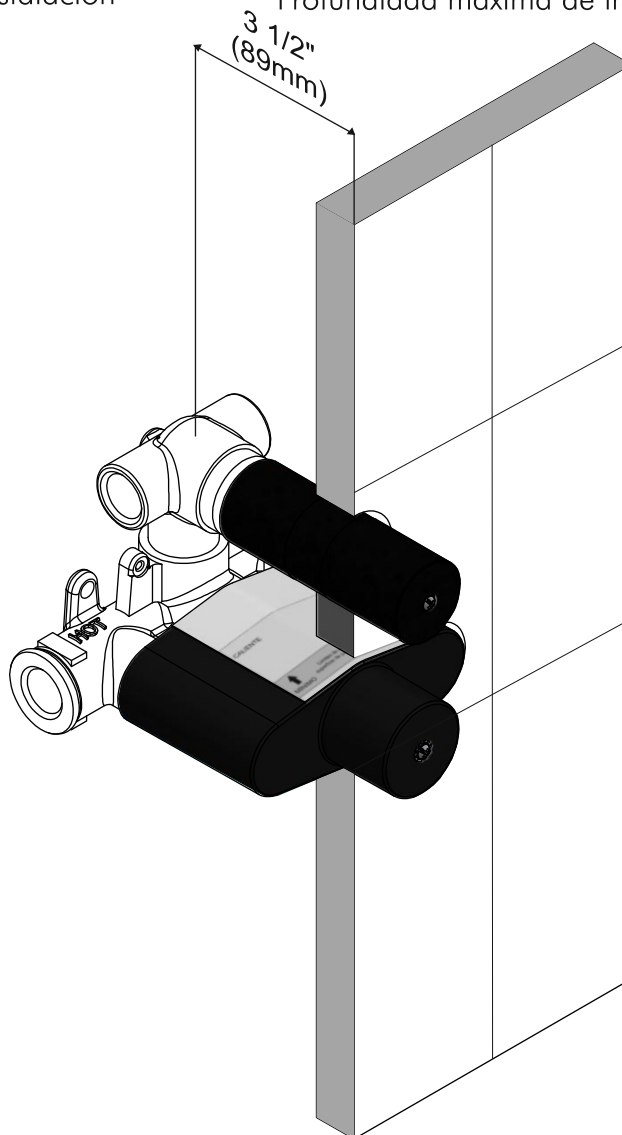

Finished wall / Final de pared

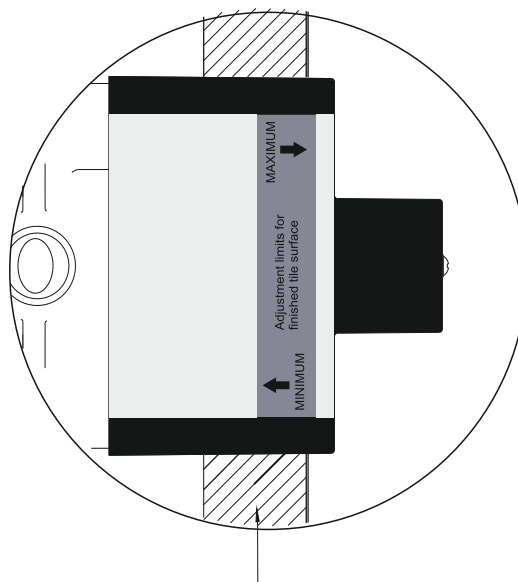

Finished wall / Final de pared

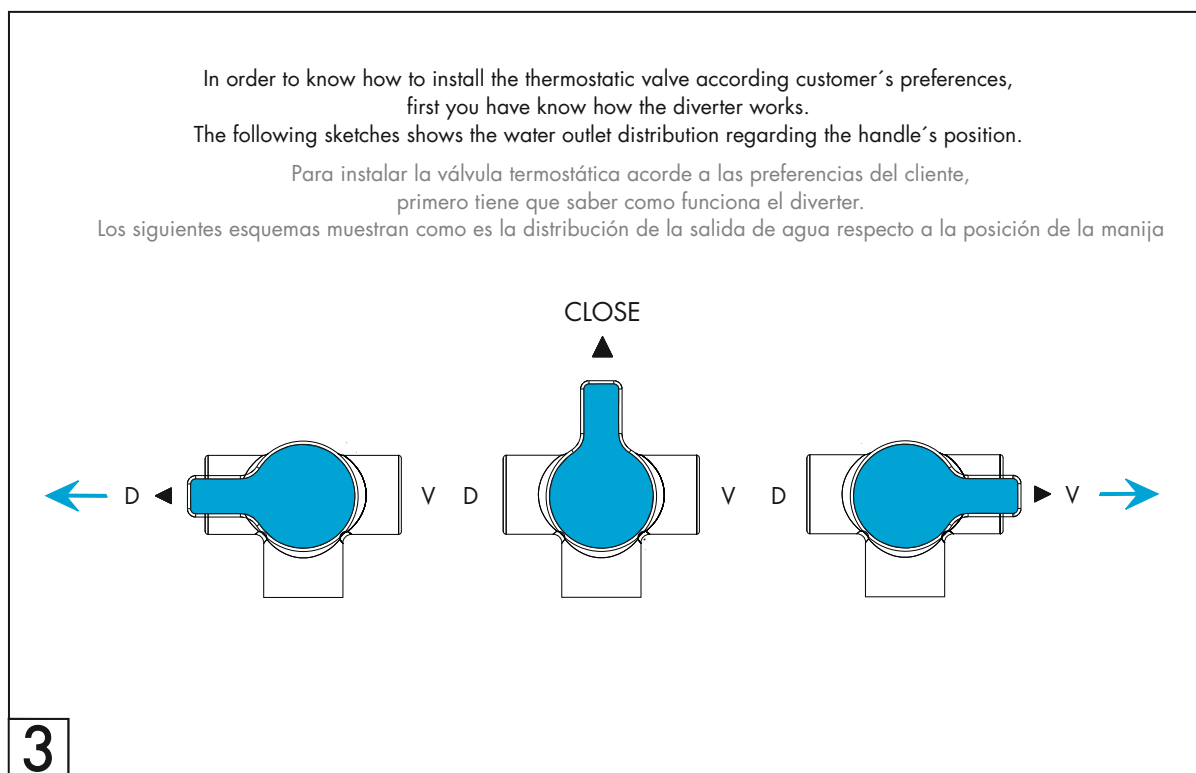
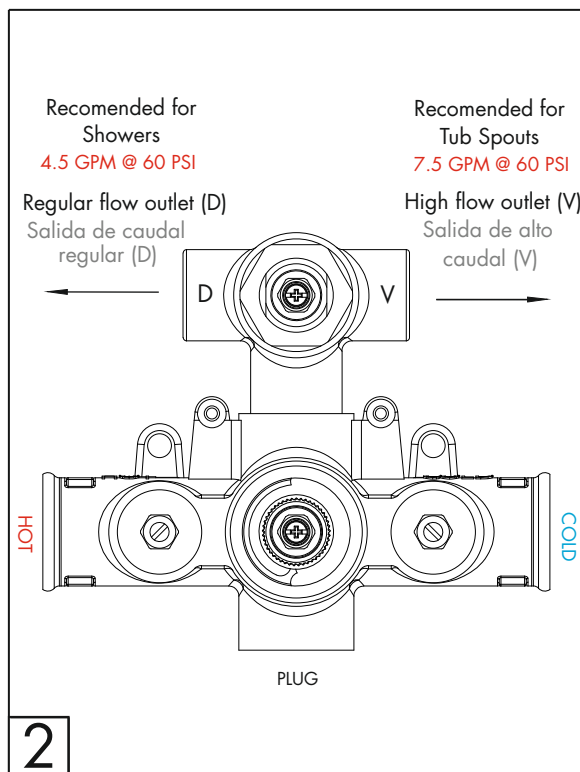
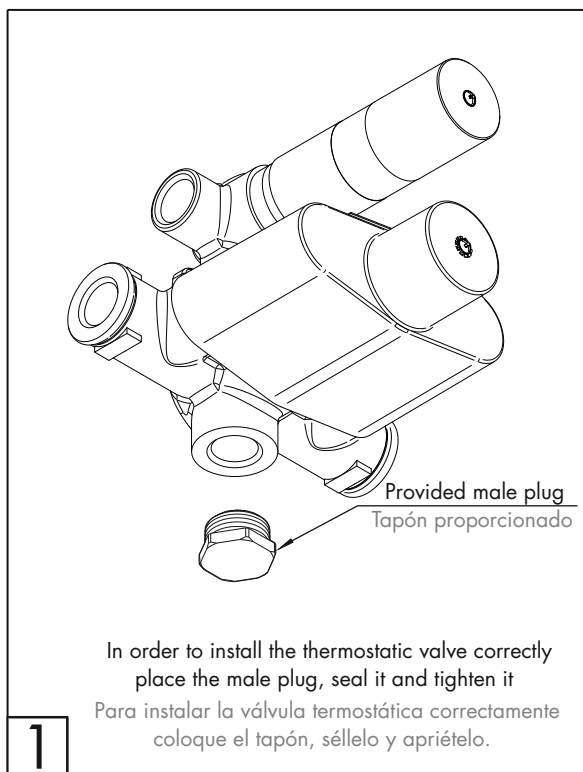

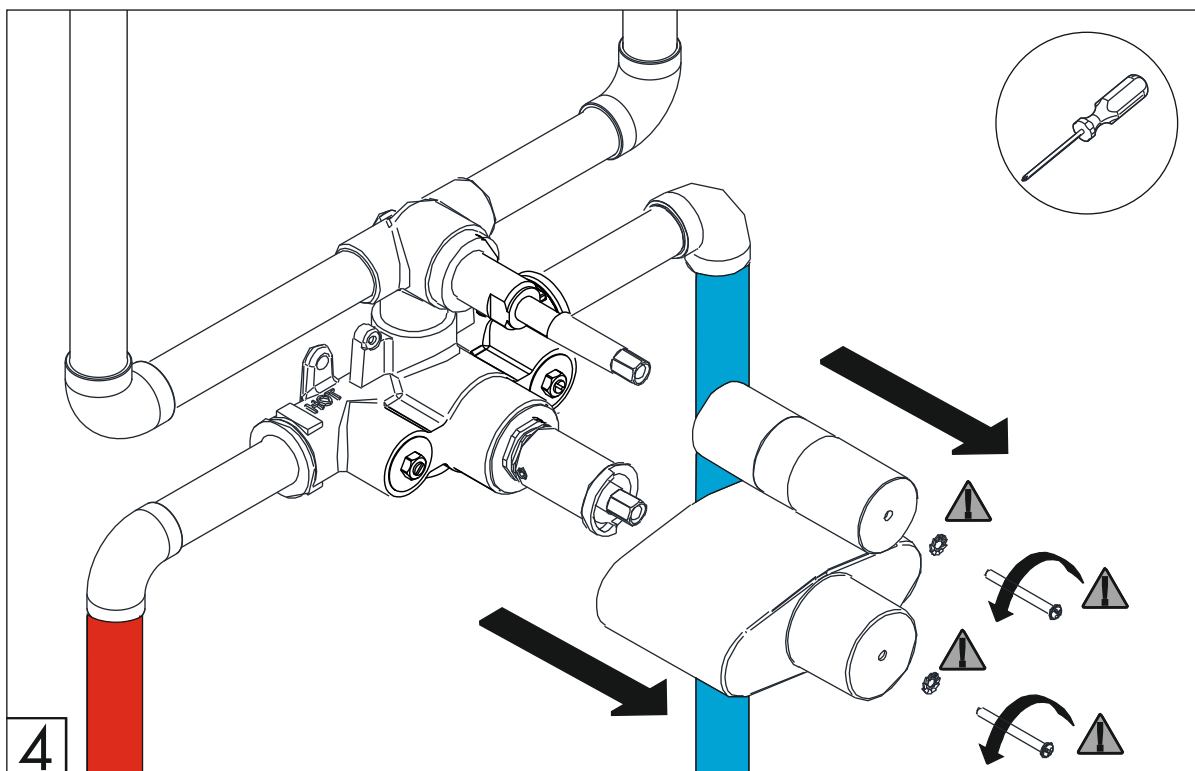

⚠ After removing the installation cover, do not discard these screws. They will be used later when installing the trim.

⚠ Después de retirar la protección de instalación no tire los tornillos. Éstos serán utilizados en el armado de la vista.

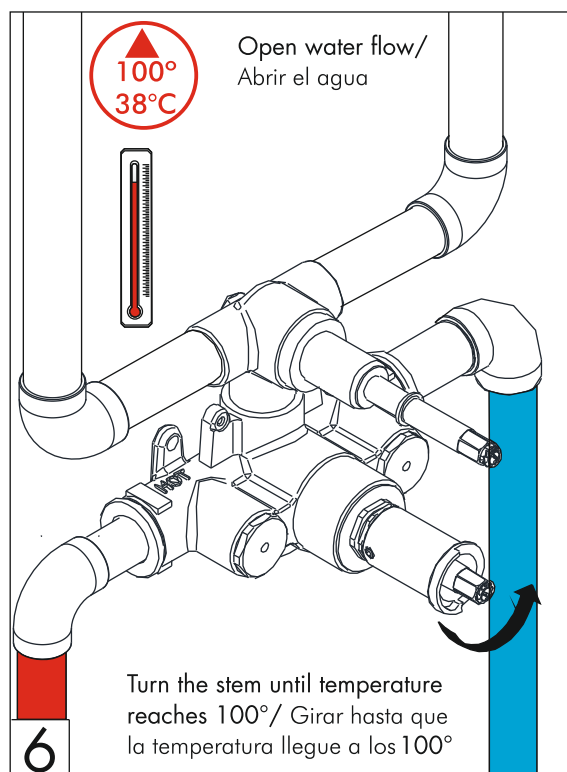
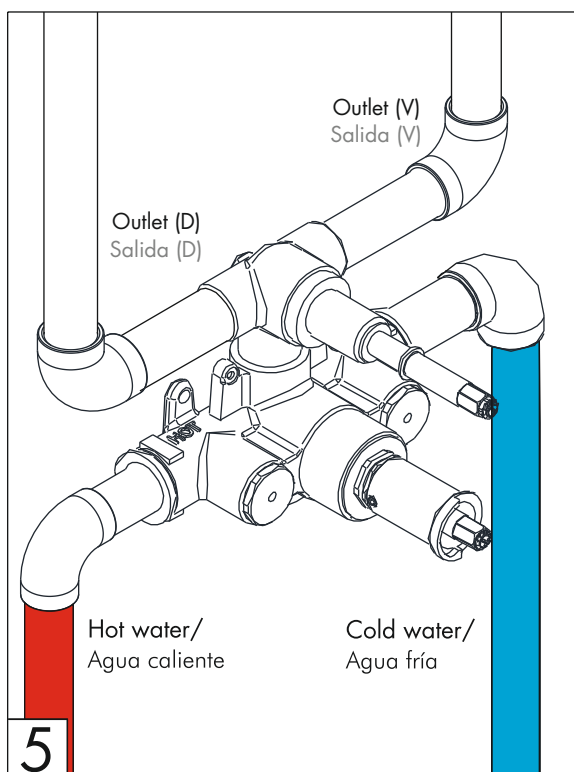

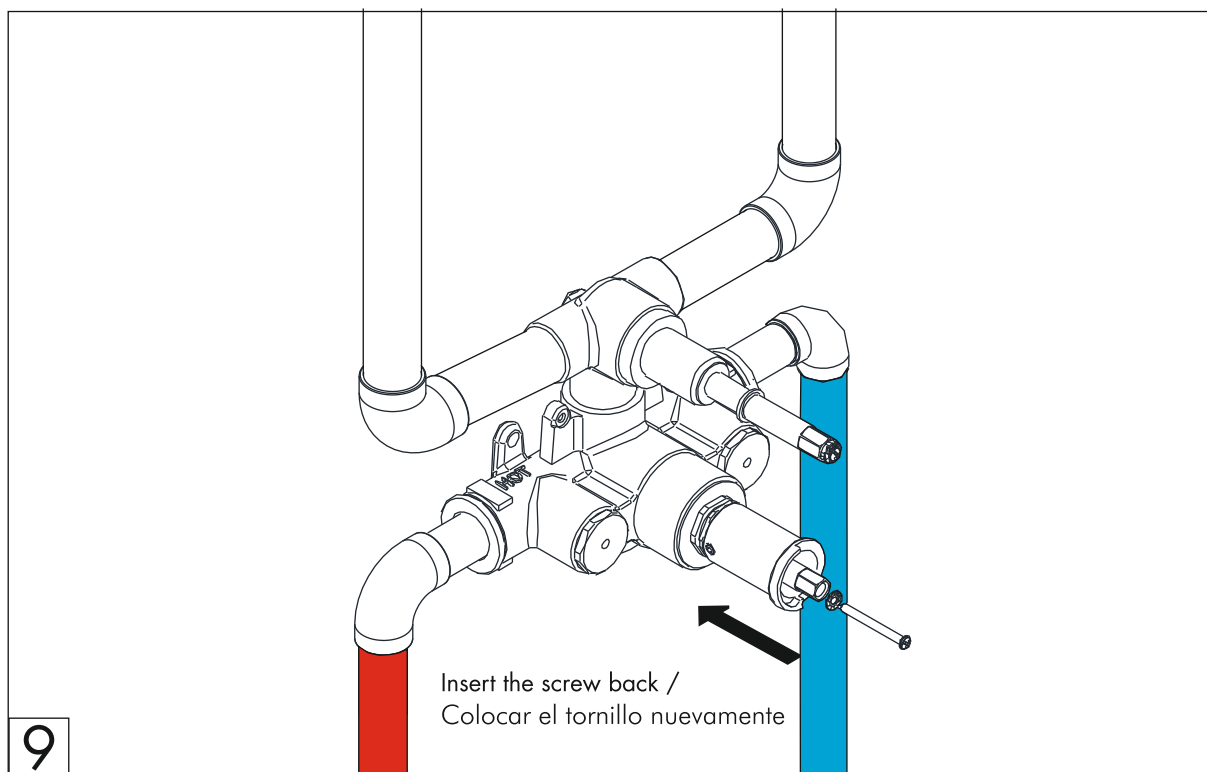
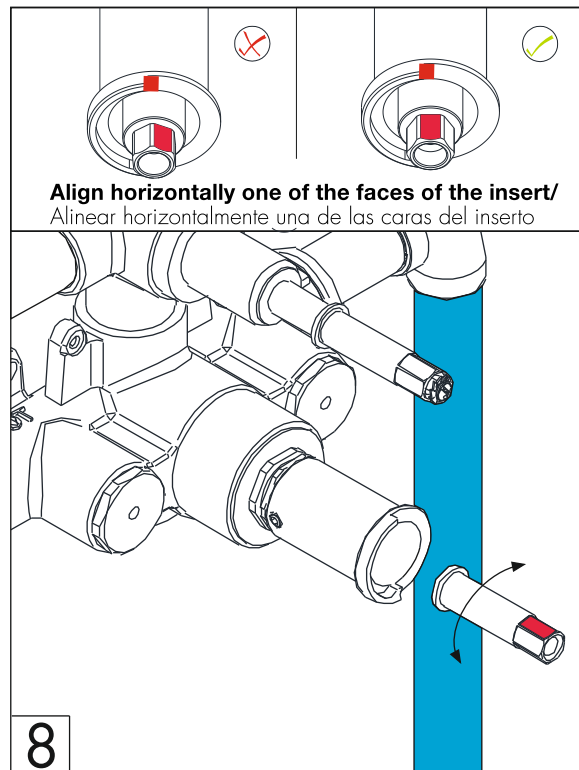
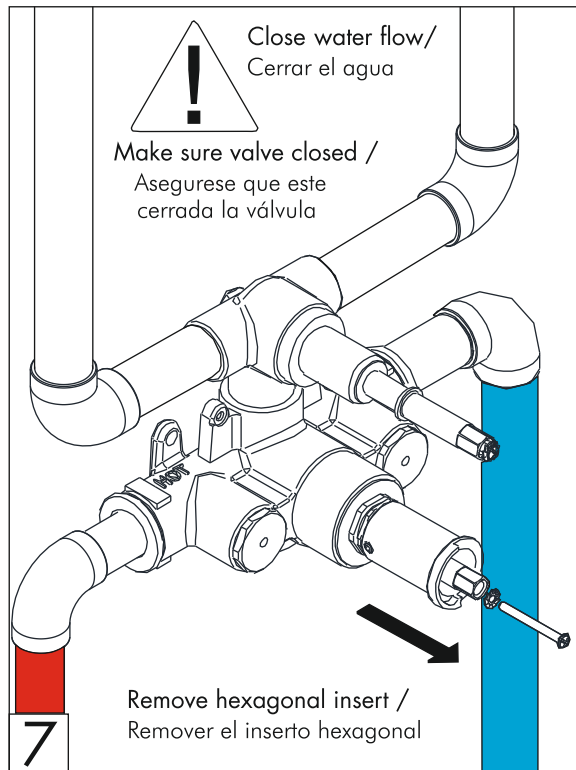

**WARRANTY:** For more information please visit <https://franzviegener.com/warranty/>

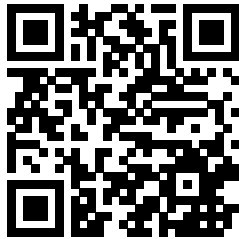

---

**FRANZ VIEGENER Customer Service Department**

Phone 847-244-3837 - [info@franzviegener.com](mailto:info@franzviegener.com).

4000 Porett Drive - Gurnee, IL, 60031-USA.

Follow us on social media!



Scan the code  
to get more  
information  
about this line.

**[www.franzviegener.com](http://www.franzviegener.com)**