

**Before connecting the faucet to the water supply, flush the tubing
thoroughly to eliminate any residue /**

Antes de conectar la grifería a la distribución de agua, purgue muy bien la cañería
a fin de eliminar partículas extrañas.

Trim for 3/4" thermostatic valve / Vista para llave de paso de 3/4"

FV217/K6K.0
FV217/K6V.0

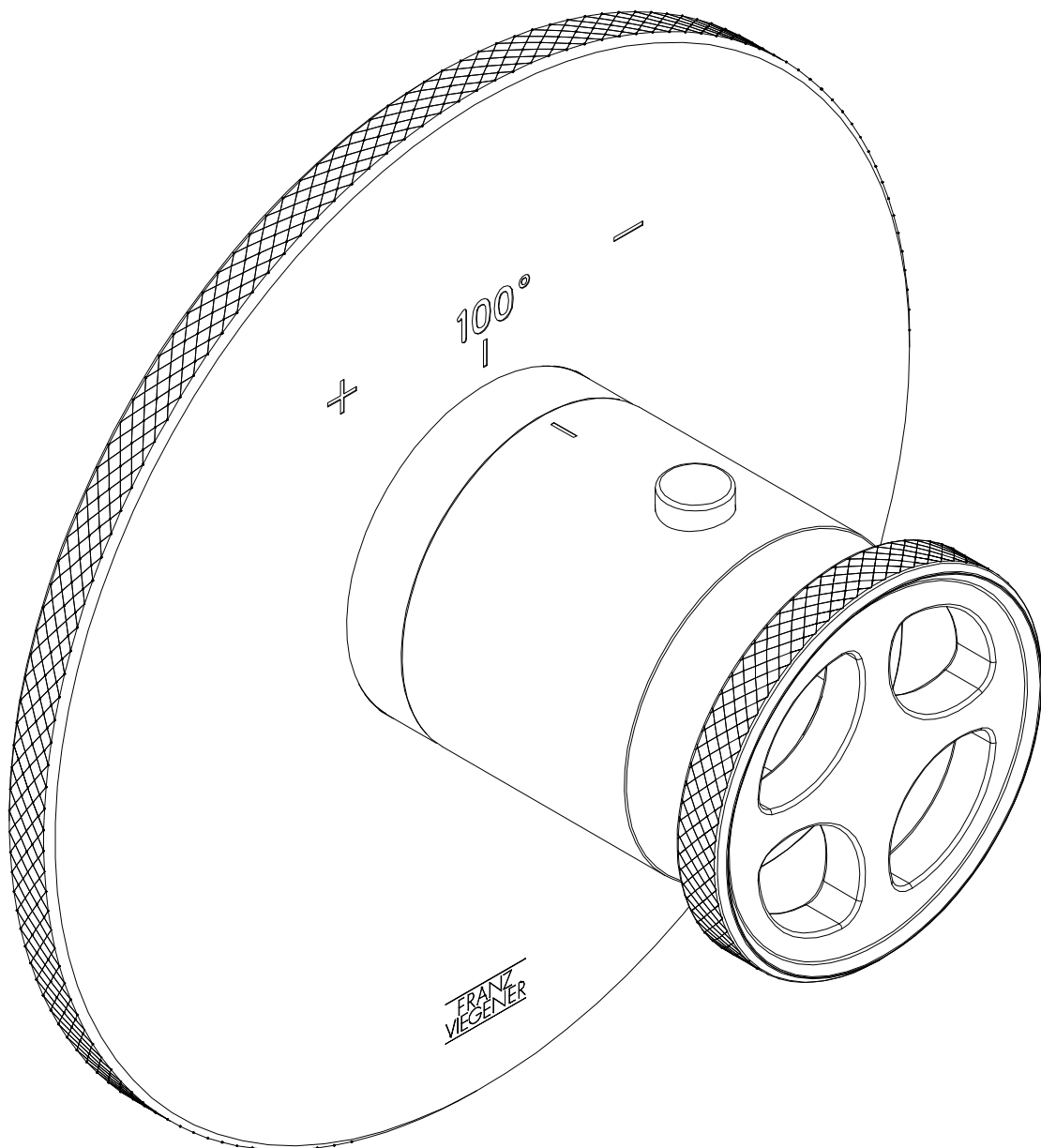

Required installation tools / Herramientas necesarias para la instalación

Provided / Provistas

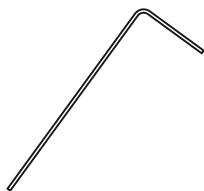

Allen Wrench
Llave Allen

Not Provided / No Provistas

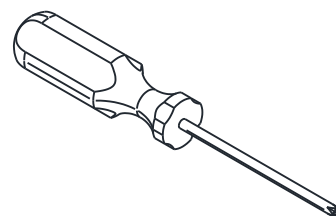

Phillips screwdriver
Destornillador Phillips

FV217/K6K.0 - FV217/K6V.0

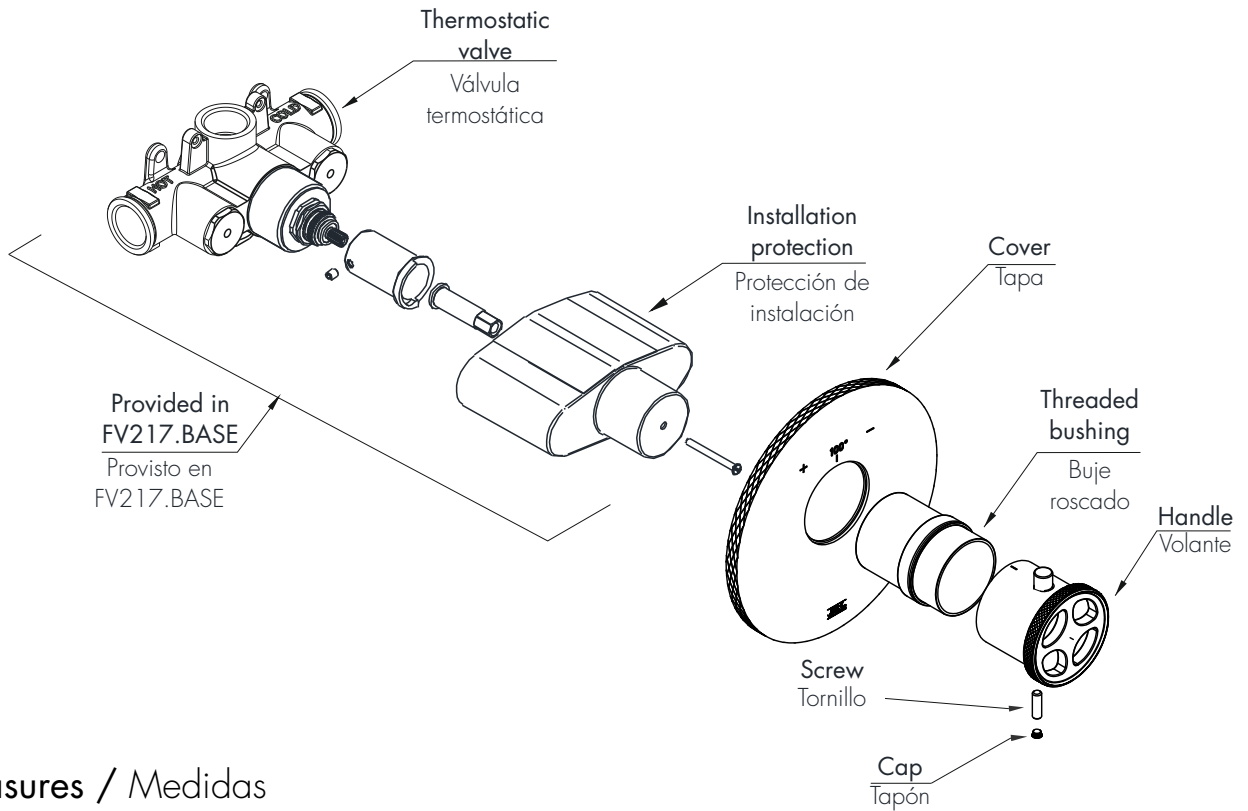

Measures / Medidas

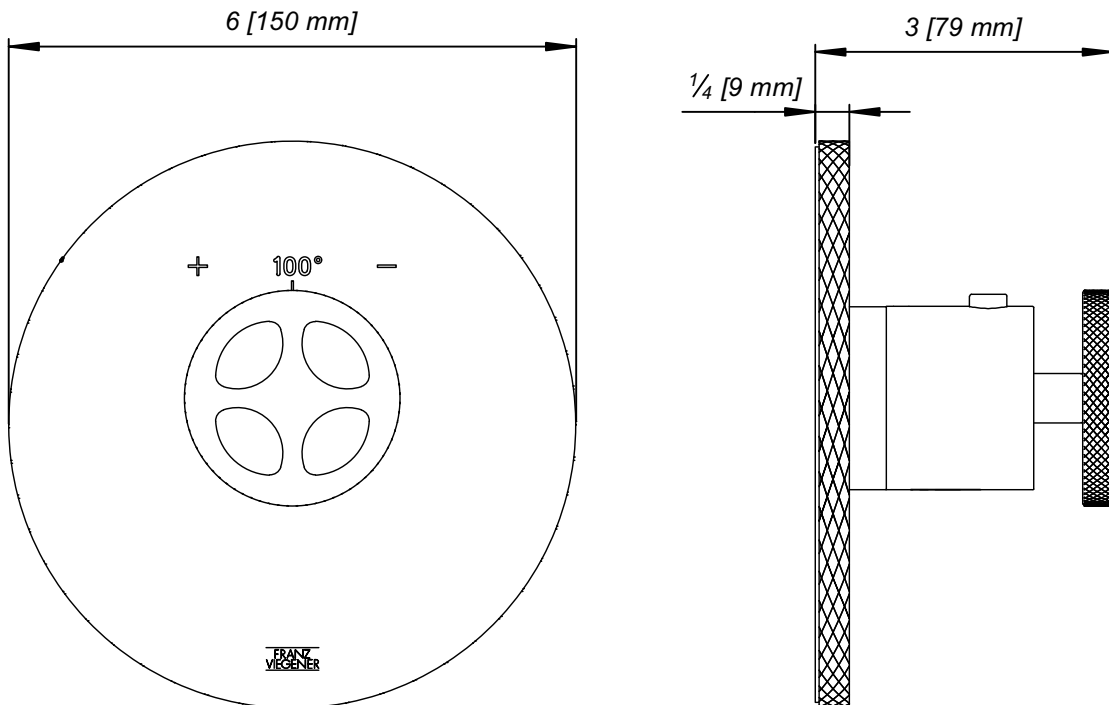

Installation / Instalación

Remove the protection / Remover la protección

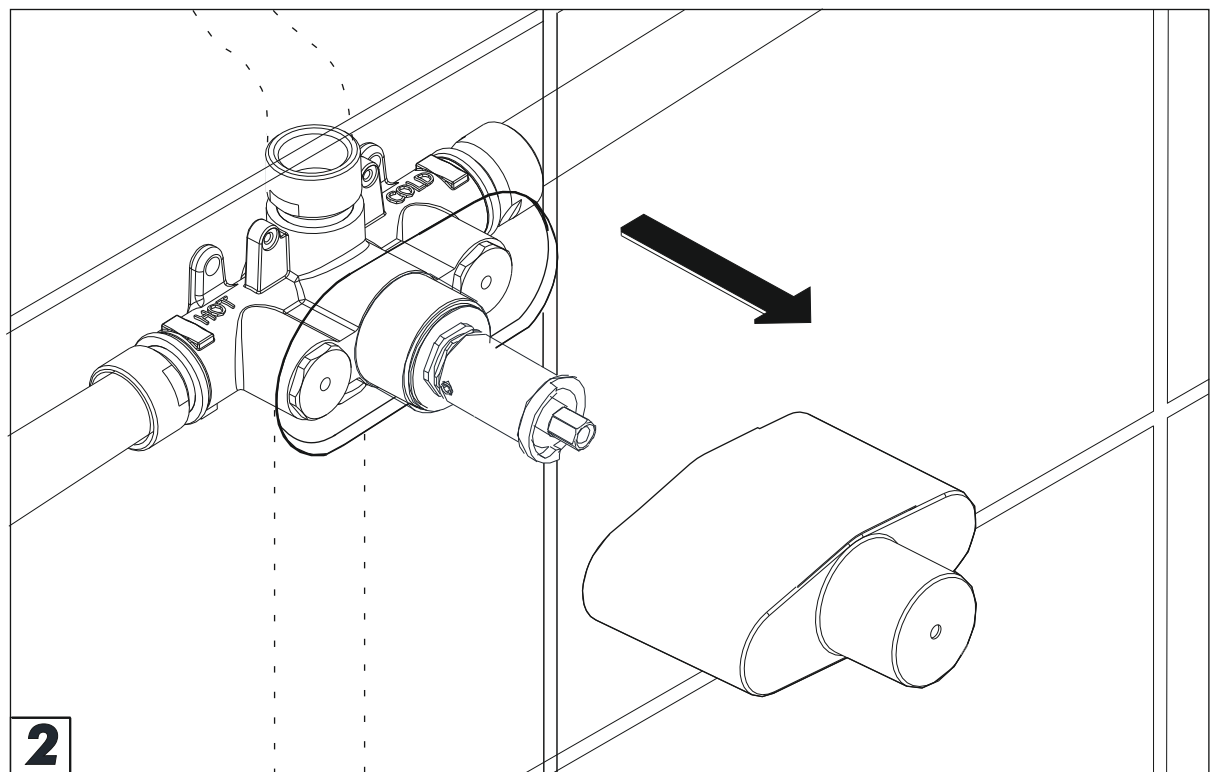
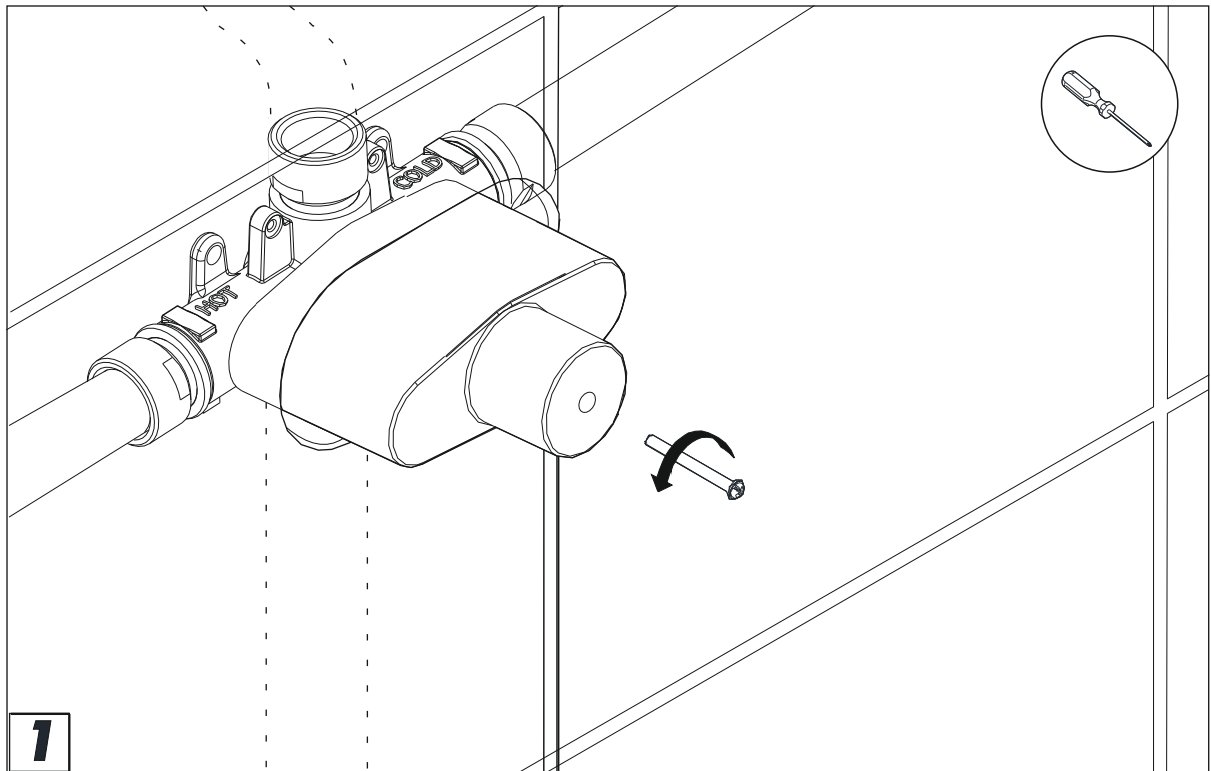

Installation / Instalación

Make sure valve closed position and water temperature /
Asegurarse que la válvula este cerrada y la temperatura del agua

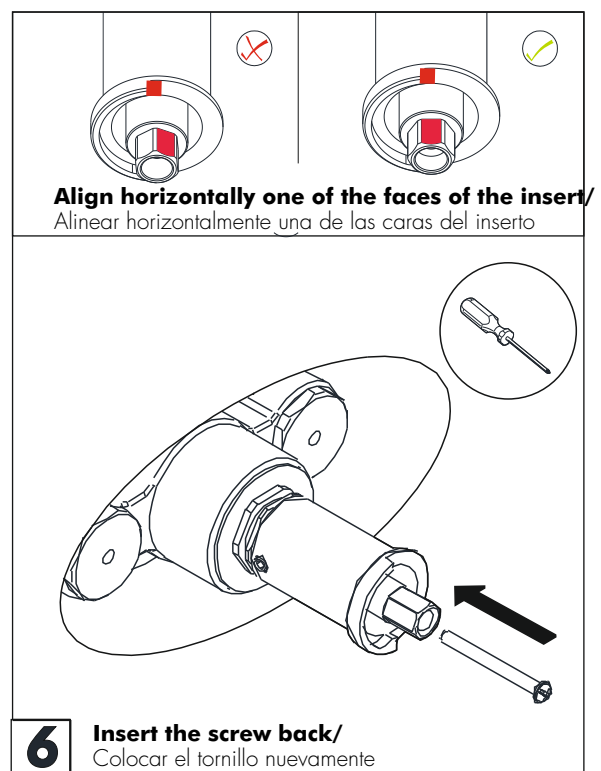
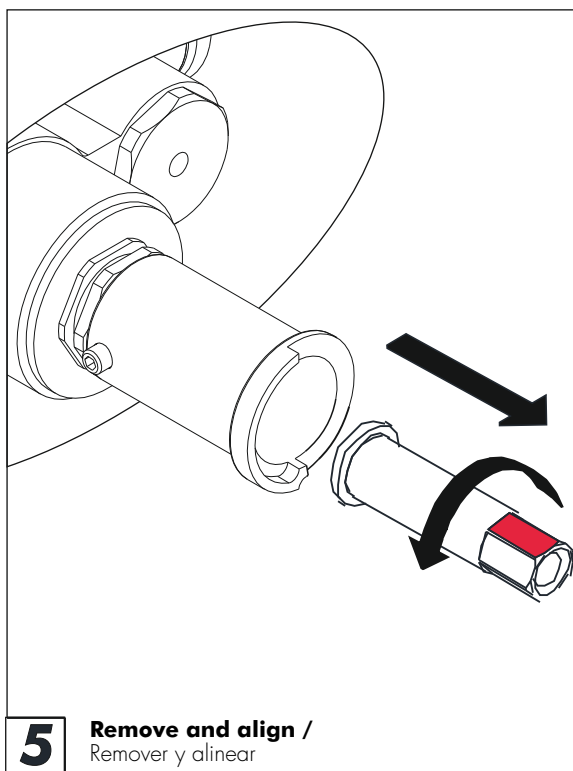
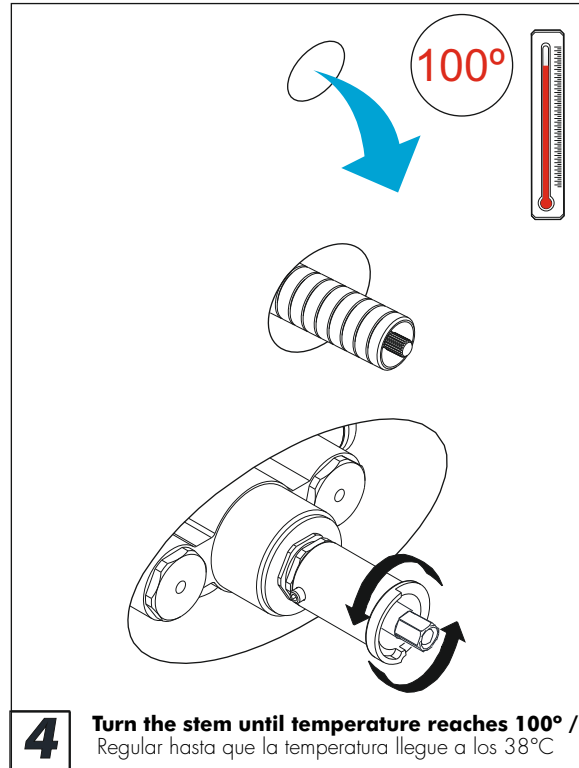
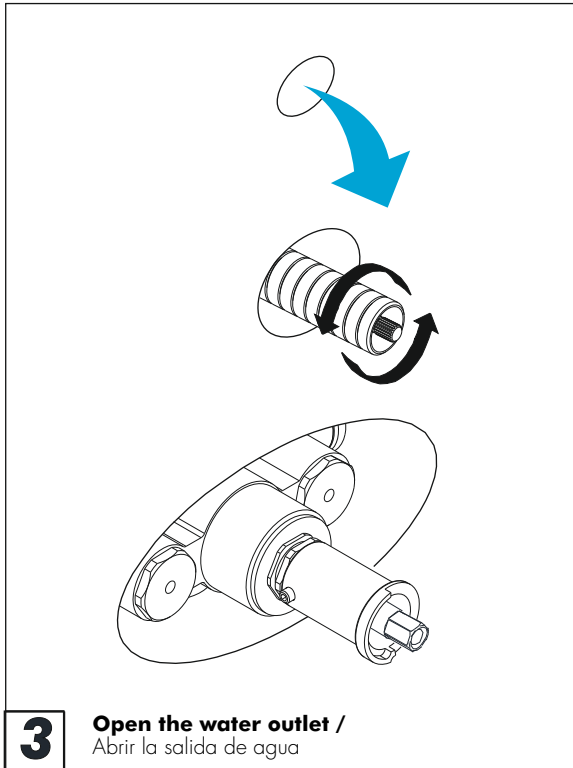

Installation / Instalación

Thermostatic trim installation / Instalación de la vista

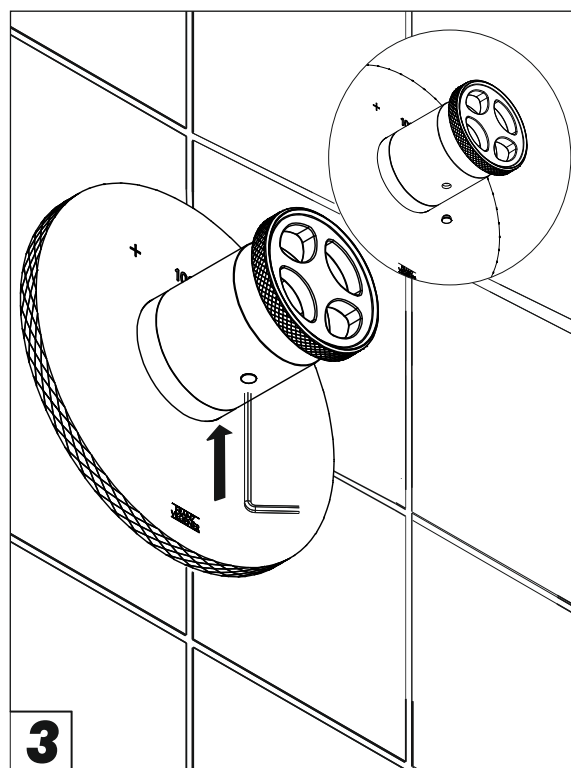
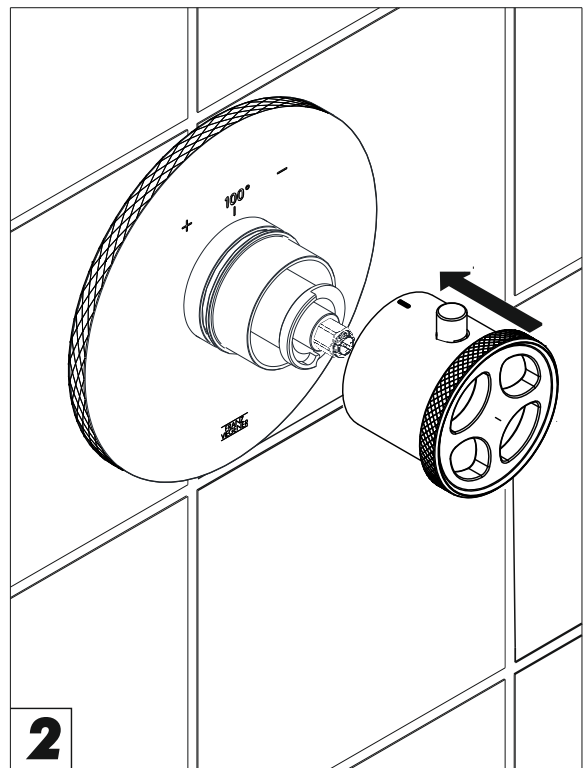
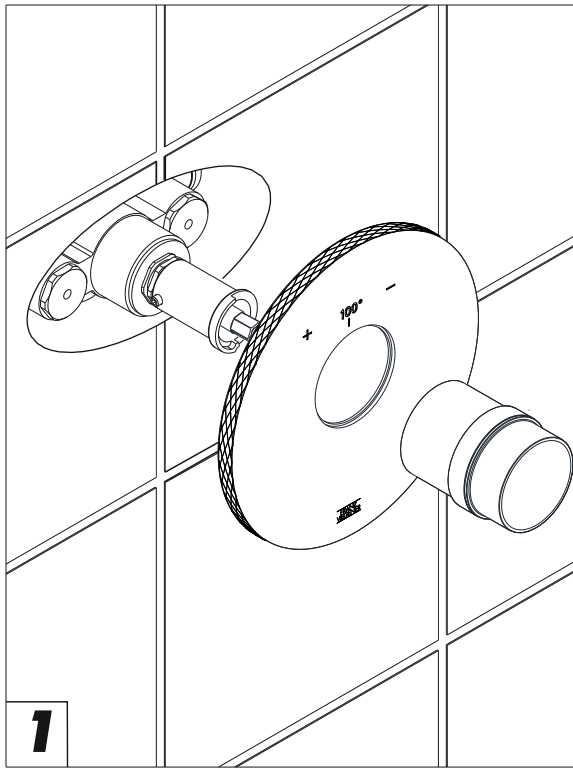

Function / Función

Temperature limit button / Botón limitador de temperatura

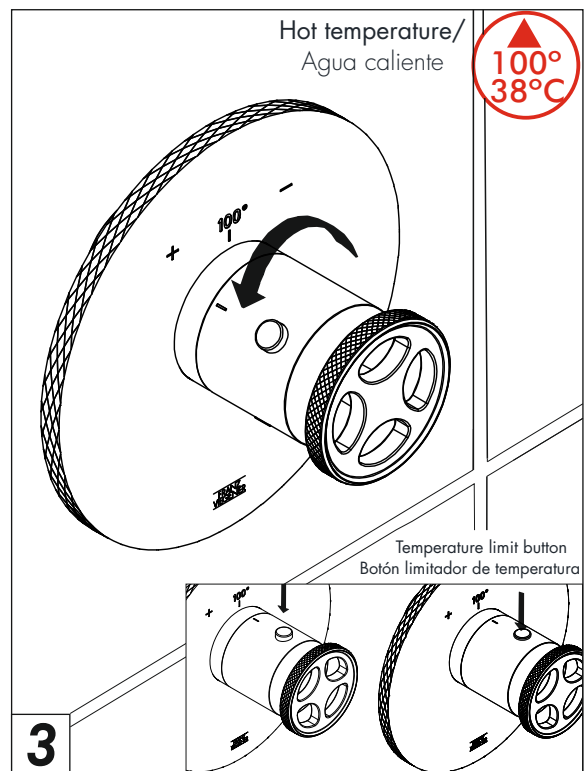
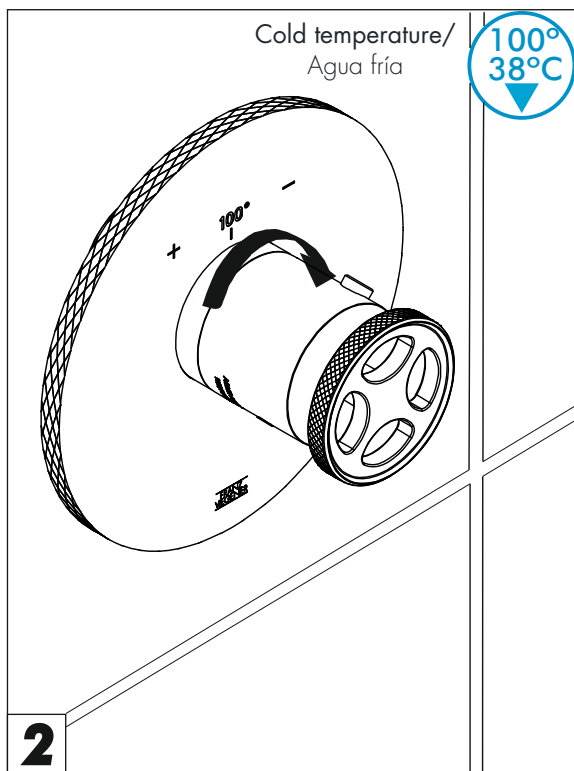
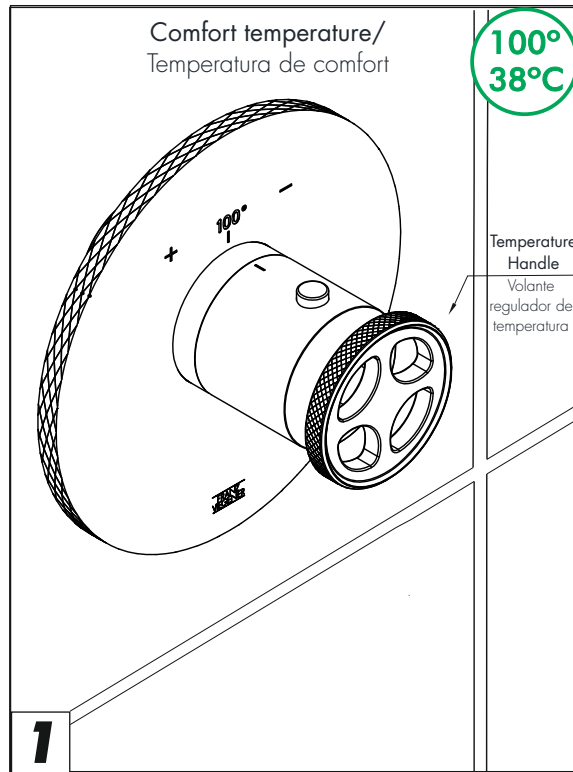

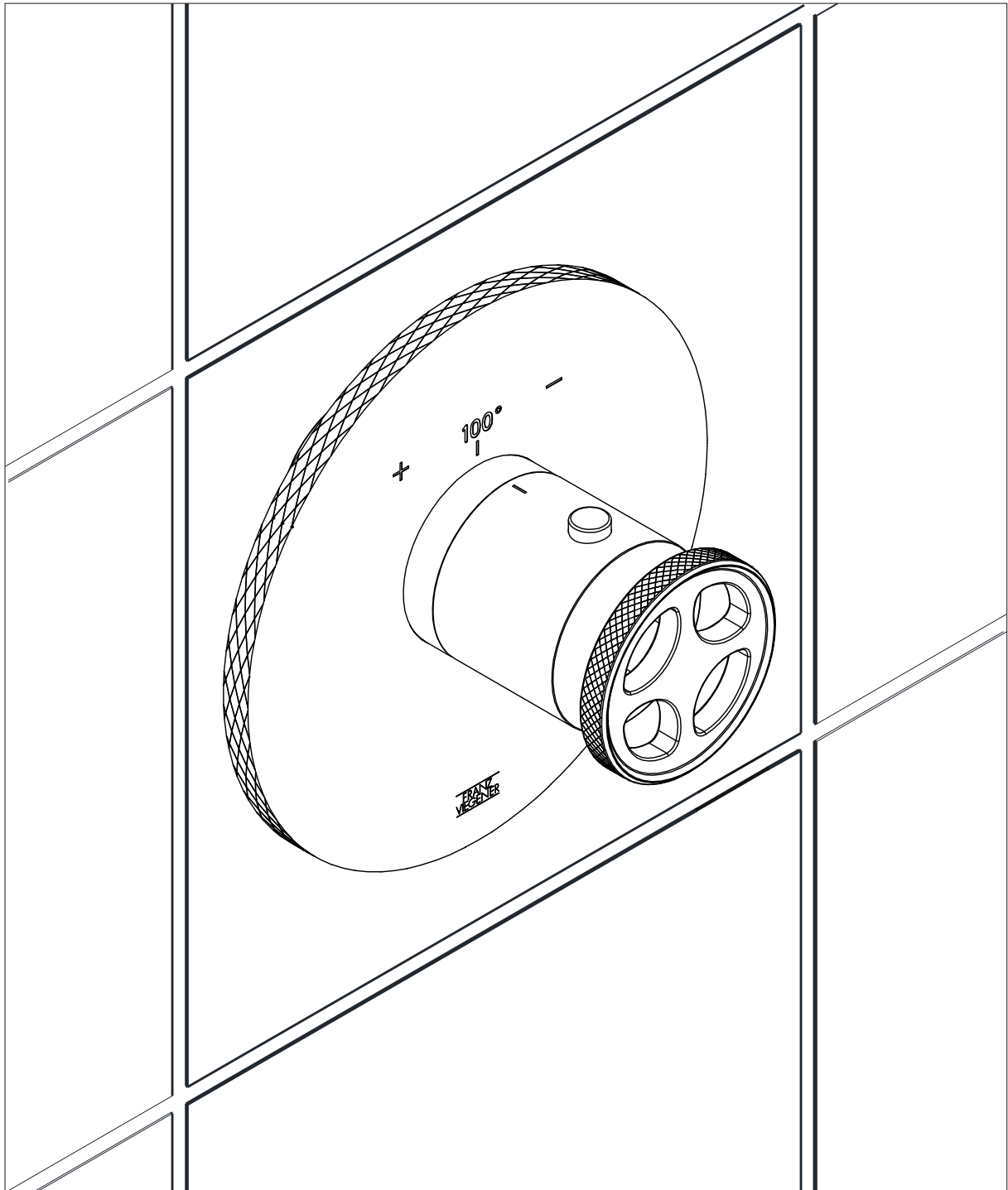

WARRANTY: For more information please visit <https://franzviegener.com/warranty/>

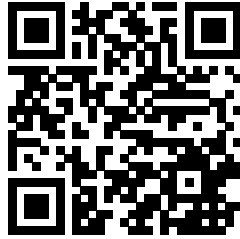

FRANZ VIEGENER Customer Service Department

Phone 847-244-3837 - info@franzviegener.com.

4000 Porett Drive - Gurnee, IL, 60031-USA.

Follow us on social media!



Scan the code
to get more
information
about this line.

www.franzviegener.com