

Installation and maintenance / Instalación y mantenimiento

Before connecting the faucet to the water supply, flush the tubing thoroughly to eliminate any residue /  
Antes de conectar la grifería a la distribución de agua, purgue muy bien la cañería a fin de eliminar partículas extrañas.

**FV126/60** - Square shower head  $\square$  150mm/ Ducha cuadrada  $\square$  150mm

**FV126/85** - Square shower head  $\square$  150mm/ ducha cuadrada  $\square$  150mm

**FV126/F4** - Square shower head  $\square$  150mm/ ducha cuadrada  $\square$  150mm

**FV126/49** - Round shower head  $\varnothing$  150mm/ ducha redonda  $\varnothing$  150mm

**FV126/59** - Round shower head  $\varnothing$  150mm/ ducha redonda  $\varnothing$  150mm

**FV126/K3** - Round shower head  $\varnothing$  150mm/ ducha redonda  $\varnothing$  150mm

**FV126.07/87** - Round shower head  $\varnothing$  230mm/ ducha redonda  $\varnothing$  230mm

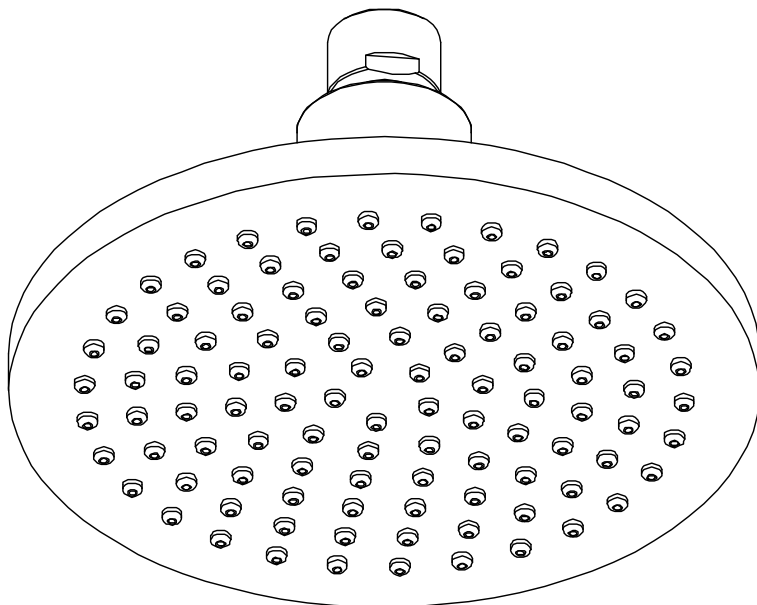

**Required installation tools / Herramientas necesarias para la instalación**

Provided / Provistas

---

Not Provided / No Provistas

---

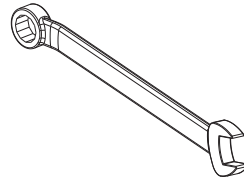

Adjustable wrench  
Llave ajustable

Measures / Medidas

---

**FV126/49**  
**FV126/59**  
**FV126/K3**  
**FV126.07/87**

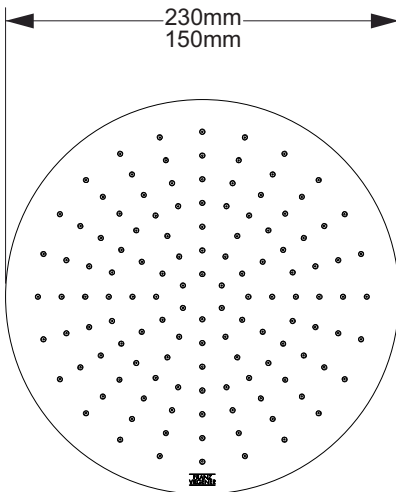

**FV126/60**  
**FV126/85**  
**FV126/F4**

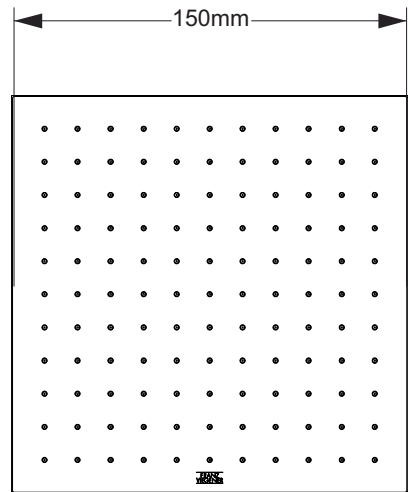

## Installation / Instalación

---

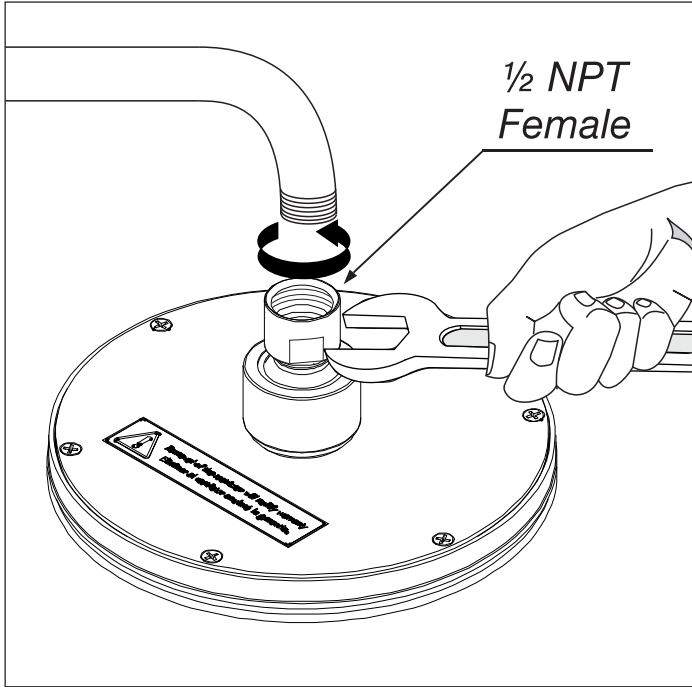

## Maintenance / Mantenimiento

---

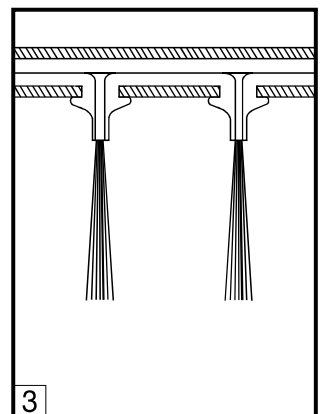
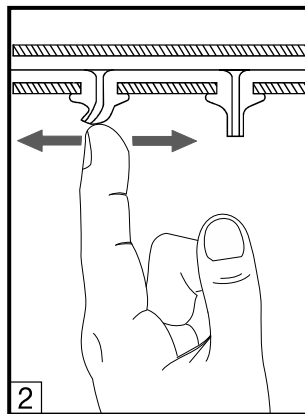
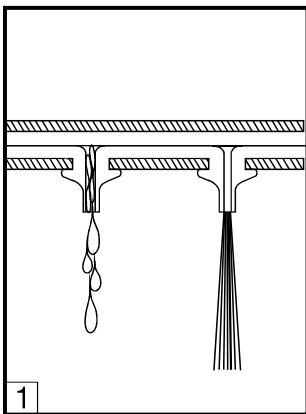

**WARRANTY:** For more information please visit <https://franzviegenger.com/warranty/>



---

**FRANZ VIEGENER Customer Service Department**

Phone 847-244-3837 - [info@franzviegenger.com](mailto:info@franzviegenger.com).

4000 Porett Drive - Gurnee, IL, 60031-USA.

Follow us on social media!



Scan the code  
to get more  
information  
about this line.

[www.franzviegenger.com](http://www.franzviegenger.com)

---

FRANZ VIEGENER reserve the right to make revisions without notice in the design of faucets and bathroom accessories or in packaging.